

# Ferguson 130 Toggle Series Curtain Wall System



## Ferguson 130 Toggle Curtain Wall

The Ferguson 130 toggle series curtain wall system provides a unique all-glass capless look in an economical stick-built curtain wall system. The system utilizes an aluminum sub-frame which is structurally adhered to the glass in a controlled plant environment prior to installation. The sub-frame is mechanically held by four-sided toggles spaced as required to meet wind loads. Hidden aluminum setting chairs carry the glass dead loads to the curtain wall mullions.

Ferguson's toggle curtain wall eliminates the need for site installation of the structural silicone, improving quality and reliability of the structural seal. Providing a four sided structural silicone flat look in a stick built system provides an economical, quality curtain wall system with quick deliveries and easy installation. Various mullion depth profiles are available based on spans, loads and the project design. Available finishes include: anodized, fluoropolymer painted and powder coated painted finish.

The curtain wall components are manufactured and engineered by Ferguson. Shop drawings and engineered details are to be submitted and approved prior to commencement of fabrication. Anchoring detail provide for adequate adjustment and compensate for building and thermal movements. Frame profiles are selected to meet all loading requirements and applicable building codes and aesthetic requirements. Provision shall be made within the system for adequate retention, structural support, and thermal movement of the glazing.

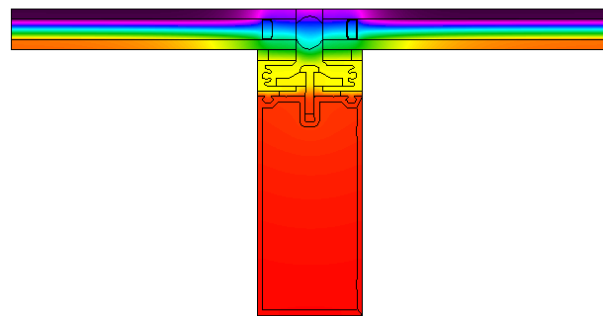
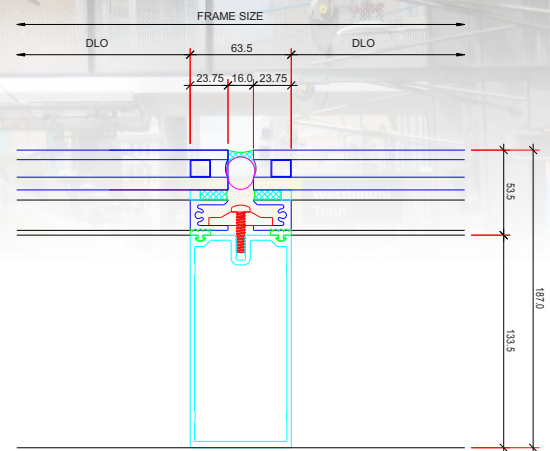

Ferguson curtain wall systems meet industry performance standards:

- Static Pressure Air Infiltration (ASTM E283)
- Static Pressure Air Exfiltration (ASTM E283)
- Static Pressure Water Infiltration (ASTM E331)
- Structural Loading (ASTM E330)
- Thermal Performance (CSAA440, NFRC 100)